

The movement-sensor reacts to temperature changes in its detection area. The range is 10 meters with an angle of 110°.

Possible interference sources can be: heating/cooling devices, air movement devices, direct daylight to sensor. The movement-sensor does not detect through a glass window, but it will send through a glass window.

Place the batteries in the sensor (fig.1 to 3). After placing the batteries, set the closing time (fig.4). The closing time depends on the width of the curtain, up to 2mtr (80") → 15sec, up to 4mtr (160") → 30sec, up to 6mtr (240") → 45sec.

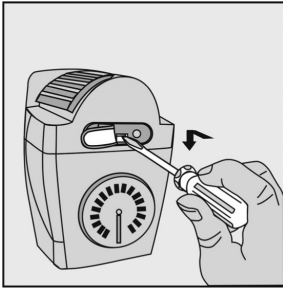

fig.1

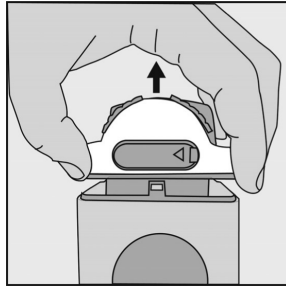

fig.2

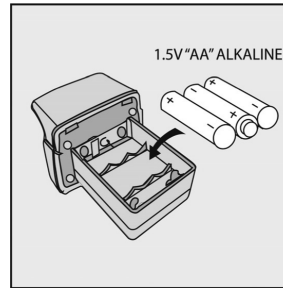

fig.3

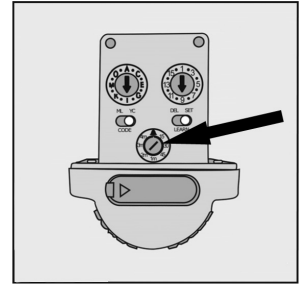

fig.4

Close the sensor (fig.5). Set the sensitivity to maximum by aiming the sensor towards a bright light source and press the button under the rubber tag (fig.6)

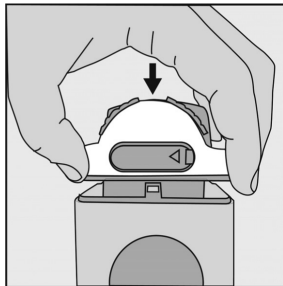

fig.5

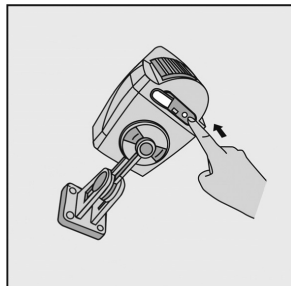
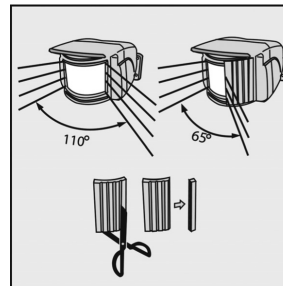

fig.6



Mount the receiver to the wall/ceiling near the Shuttle motor. Connect the connector to port 2 (fig.8) of the Shuttle and put the plug into a wall outlet. If necessary, connect the supplied switch to the 230V cable for switching off the sensor.

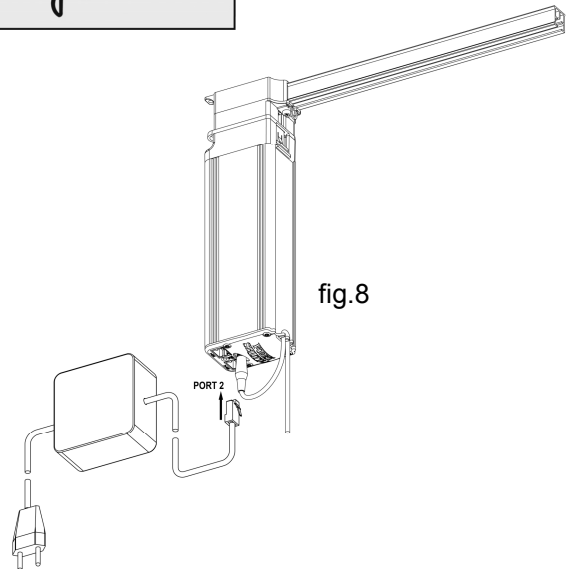

fig.8

Operation: when movement is detected the curtain will close. After 15, 30 or 45 seconds the curtain will open again. When movement is detected continuous, the curtain will not close again after opening. After no movement for 5 seconds or more the curtain will move again.

When this device doesn't work correct, check the batteries and set the sensitivity again to maximum by aiming the sensor towards a bright light source and press the button (fig.6)